

Certificate in ESOL Skills for Life



Entry 2—Reading

March 2005

YOUR FULL NAME:
(BLOCK CAPITALS)

CENTRE: DATE:

CANDIDATE REGISTRATION NUMBER:

TIME ALLOWED: 45 MINUTES

PLEASE ANSWER **ALL** QUESTIONS. **WRITE** YOUR ANSWERS IN PEN **NOT** PENCIL.

EXAMINER'S USE ONLY

Q1	Q2	Q3	Q4	Q5	Q6	Q7	Q8	Q9	Q10	Q11	Q12	Q13	Q14	Q15	Q16	Q17	Q18	Q19	Q20

Certificate in ESOL Skills for Life Entry 2—Reading

Time allowed: 45 minutes.

Task one

Answer the questions on page 3 by using the diagram and instructions below.

Sunflower Sow & Grow Kit

Sunflower Tall Single

Height 180–270cm (6–9")

Sow Seeds: February–May

Plant Out: Late April–Early June

Flowers Appear: July–September

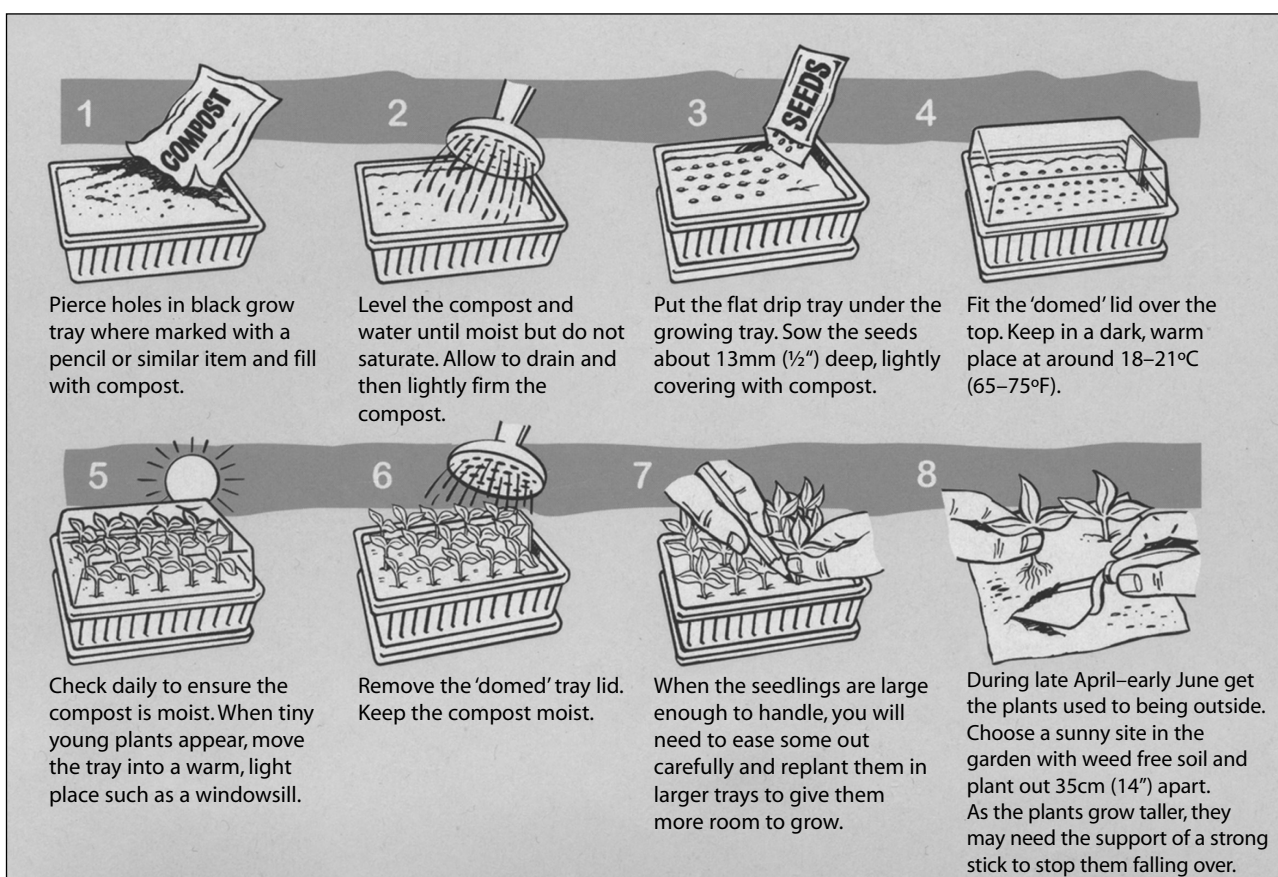

Glossary

Compost—a mixture of old leaves and manure which feeds plants

Drain—let the extra water run out of the tray

Level—to make flat

Moist—a little wet

Pierce—to make a hole with a sharp instrument

Saturate—to make very wet

Sow—to put seeds in the ground

Source: Sutton's Seeds Sunny
Sunflower Sow and Grow Kit

Questions

1. Complete the sentence:

The text tells you how to and

2. Where can you find a text like this? (*Please circle the letter of the correct answer*)

- A** On a box
- B** In a newspaper
- C** In a catalogue

3. Which sentence is correct? (*Please circle the letter of the correct answer*)

- A** The sunflowers grow to a height of 170–280cm and flower from June to September.
- B** The sunflowers grow to a height of 180–270cm and flower from July to September.
- C** The sunflowers grow to a height of 160–270cm and flower from April to July.

4. Look at the diagram.

In which order do these things go into the tray? (*Please circle the letter of the correct answer*)

- A** Seeds Compost Water
- B** Water Seeds Compost
- C** Compost Water Seeds

5. Look at the glossary and the instructions.

Which sharp instrument does the text tell you to use to make holes?

.....

6. How often do you check the compost is moist?

.....

7. Look at the glossary. What does the compost do to the plants?

.....

8. Insert the correct word in the space.

because	before	however	and	after
----------------	---------------	----------------	------------	--------------

Put the drip tray under the growing tray you sow the seeds.

Questions continued over the page ►

Task one (continued)

9. Insert the correct word or words in the space.

pencil plants water growing tray strong stick

The kit contains compost, seeds, a drip tray, a and a domed lid.

10. Which is the correct order. (*Please circle the letter of the correct answer*)

A	Then grow the seedlings in a warm, light place. First, grow the seeds in a dark, warm place. Finally, plant the sunflowers outside when they are large enough.
B	Finally, plant the sunflowers outside when they are large enough. First, grow the seeds in a dark, warm place. Then grow the seedlings in a warm, light place.
C	First, grow the seeds in a dark, warm place. Then grow the seedlings in a warm, light place. Finally, plant the sunflowers outside when they are large enough.

Task two

Answer the questions on page 5 by using the form below.

<h2 style="margin: 0;"><i>Beautiful Gardens</i></h2>																					
Name:																					
Address:																					
.....	Postcode:																				
Please choose from the options below:																					
3 months £14 <input type="checkbox"/>	12 months £50 <input type="checkbox"/>																				
6 months £27 <input type="checkbox"/>	24 months £95 <input type="checkbox"/>																				
Please make your cheque payable to 'Beautiful Gardens' or fill in your credit card details below:																					
Mastercard/Visa Expiry date:	Name on card:																				
(Delete as appropriate)																					
Card number	<table border="1" style="display: inline-table; border-collapse: collapse; text-align: center;"> <tr> <td style="width: 20px; height: 20px;"></td> <td style="width: 20px; height: 20px;"></td> <td style="width: 20px; height: 20px;"></td> <td style="width: 20px; height: 20px;"></td> <td style="width: 20px; height: 20px;"></td> <td style="width: 20px; height: 20px;"></td> <td style="width: 20px; height: 20px;"></td> <td style="width: 20px; height: 20px;"></td> <td style="width: 20px; height: 20px;"></td> <td style="width: 20px; height: 20px;"></td> <td style="width: 20px; height: 20px;"></td> <td style="width: 20px; height: 20px;"></td> <td style="width: 20px; height: 20px;"></td> <td style="width: 20px; height: 20px;"></td> <td style="width: 20px; height: 20px;"></td> <td style="width: 20px; height: 20px;"></td> <td style="width: 20px; height: 20px;"></td> <td style="width: 20px; height: 20px;"></td> <td style="width: 20px; height: 20px;"></td> <td style="width: 20px; height: 20px;"></td> </tr> </table>																				
Please send to: Beautiful Gardens, Beaufort House, Ellis Lane, High Hill, Edinburgh E4 8YH																					
Tick the box to get a free packet of seeds with your first magazine <input type="checkbox"/> (This offers applies to UK residents only)																					

Questions

Look at the task two form on page 4 and answer the following questions. For each question, only one of the answers is correct.

(Please circle the letter of the correct answer)

11. This form is to
 - A** join a club
 - B** order a magazine
 - C** apply for a credit card

12. The form asks you to delete the Mastercard or Visa card. Which one is correct?
 - A** Mastercard/Visa ✕
 - B** Mastercard/Visa ✓
 - C** ~~Mastercard/Visa~~

13. You want to pay by cheque for six months. What do you write on the cheque?
 - A** Six months at £27
 - B** Pay £27
 - C** Pay 'Beautiful Gardens' twenty seven pounds only

14. Who can get a free packet of seeds? People who live
 - A** in Britain
 - B** in France
 - C** anywhere

15. The form does **not** ask
 - A** what is your address?
 - B** what is your name?
 - C** what is your telephone number?

Task three

Answer the questions on page 7 by using the information below.

Manchester Coaches Departures					
Destination	Times				Bay
Blackpool	8.30	12.30	14.30	18.00	1
Chester	10.00	<i>and every hour until</i>		20.00	2
Derby	8.30	12.30	14.30	19.30	3
Edinburgh	6.30	12.00	15.00	18.00	4
Liverpool	9.00	13.00	15.00	21.00	3
Matlock	7.30	<i>and every hour until</i>		18.00	5
Nottingham	9.00	<i>and every two hours until</i>		15.00	6
Preston	6.30	<i>and every hour until</i>		21.30	7
Scarborough	11.00	14.00	16.00	19.00	4
Warrington	8.00	<i>and every hour until</i>		17.00	8

Questions

Look at the text on page 6 and answer the following questions. For each question, only one of the answers is correct.

(Please circle the letter of the correct answer)

16. This text can be found
- A** in a book
 - B** on a noticeboard
 - C** in a shop
17. Where would **Formby** come in the list?
- A** After **Liverpool** and before **Matlock**
 - B** After **Chester** and before **Derby**
 - C** After **Edinburgh** and before **Liverpool**
18. Bay 3 is where you get the coaches for
- A** Liverpool and Chester
 - B** Nottingham and Warrington
 - C** Derby and Liverpool
19. Which two places can you get a coach to at 6.30?
- A** Preston and Edinburgh
 - B** Chester and Blackpool
 - C** Liverpool and Scarborough
20. Which place does a coach depart to every two hours?
- A** Nottingham
 - B** Preston
 - C** Scarborough

